

QUICKSPOT AND SLIDEHOLDER Q PATH

According to standard ISO 18113-2 : 2009, Point 7 Requirements for instructions or use and consolidated Directive 98/79/EC

PRODUCT NAME

Cat. No	Description	Pack Size
VWRI630-2093	Slide Holder Q path for Turbitec	PCS
VWRI630-2094	QuickSpot Q path for Turbitec	Box of 500 PCS

INTENDED PURPOSE

The *Q Path Slide holder for Turbitec* and *Q Path QuickSpot for Turbitec* are centrifugation accessories used to carry out cyto-centrifugation.

They allow a cell suspension to be deposited on a slide (gynecological or non gynecological samples in liquid medium such as urine, etc.).

The *Q Path Slide holder for Turbitec* is a support for positioning the slide and the *Q Path QuickSpot for Turbitec* is the sample filling chamber.

These 2 accessories fit together. They must be used together.

WARNING AND PRECAUTIONS



1. The Slide holder is a re-usable accessory, adapted for DIV
2. The QuickSpot is single use, adapted for DIV
3. These two accessories were designed to be used with Hettich® centrifuges
4. Follow the assembly instructions
5. Comply with the maximum filling volumes
6. Wear gloves when handling accessories and samples
7. Comply with the storage conditions for the Slide holder and the QuickSpot for Turbitec

COMPOSITION

- Mixture of plastic components

STORAGE AND SHELF LIFE

Consult expiry date on packaging. Opening the package does not change the expiry date if the stipulated storage conditions are followed.

ADDITIONAL SPECIAL EQUIPMENT

- ✓ Hettich® centrifuge (Rotofix 32A, Rotina 38, Rotina 420 type, etc.) equipped with a rotor with frames compatible with the Slide holders for Turbitec.



03/2010



VWR International SAS
201 rue Carnot
94126 Fontenay-sous-bois
France



QUICKSPOT AND SLIDEHOLDER Q PATH

SPECIMENS

- ✓ Type of sample: cytological samples
- ✓ Special sampling conditions: sampling in suspension
- ✓ Pre-treatment: refer to the technique used.
- ✓ Storage conditions: refer to the technique and consumables used

MODE OF OPERATION

1. Take one Q Path Slide holder for Turbitec, one Q Path QuickSpot for Turbitec and a glass object-slide (standard slide, pre-treated slide, etc.)
2. Insert the slide in the "Slide holder"
3. Use your thumb to maintain /retain the slide in the support to prevent the slide coming back out when the QuickSpot is tightened on the Slide holder.
4. Take the QuickSpot, place it in the centre of the Slide holder and turn it a quarter-turn clockwise in order to tighten the unit.

Q Path Slide holder for Turbitec

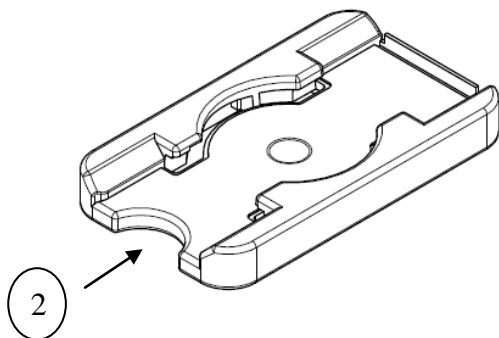

Q Path QuickSpot for Turbitec

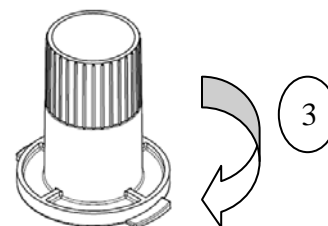

5. Pipette a sample and place it in the Q Path QuickSpot for Turbitec. In order to find out the quantity of sample to be pipetted, reference must be made to the type of analysis you wish to make.
⇒ The QuickSpot has several scales: 1.5ml, 4.5ml and 7.5ml.
6. Place your Slide holder and Quickspot unit in your centrifuge
7. Check that this is balanced
8. Centrifuge the samples (check the time and the speed of centrifuging in relation to the analyses you wish to carry out)
9. Pour off the supernatant after centrifuging.
10. Leave the remaining liquid to evaporate before dismantling the QuickSpot.
11. Use your thumb to maintain /retain the slide in the support to prevent the slide coming back out when the QuickSpot is dismantled.
12. Dismantle the QuickSpot by turning anticlockwise.
13. Remove the slide from the Slide Holder
14. If necessary, allow the remaining liquid still on the slide to evaporate.
15. Stain the slides appropriately

QUICKSPOT AND SLIDEHOLDER Q PATH

METHODOLOGY

- PRINCIPLE OF THE METHOD

The unit of 3 elements: Q Path Slide holder, Q Path QuickSpot for Turbitec and object-slide allows the cell suspension to be deposited on the slide. (gynecological or non gynecological samples in liquid medium such as urine, etc.)

- METHOD CHARACTERISTICS AND PERFORMANCE LIMITATIONS

The Q Path QuickSpot for Turbitec is a single-use centrifugation chamber. The sampling volume is limited to 8 ml per chamber.

The Q Path Slide holder for Turbitec will be able to carry out 600 tests well. It must be appropriately disinfected each time it is used.

The number of uses may vary depending on how the equipment is maintained.

The Q Path Slide holder and Q Path QuickSpot for Turbitec can resist a centrifugal force of 2039g for 30 minutes.

They can resist alcohol and water for 4 days.

The Q Path Slide holder for Turbitec and Q Path QuickSpot for Turbitec have been designed for use with Hettich® centrifuges

REAGENT PREPARATION

Not applicable

LITERATURE REFERENCES

Not applicable.

AFTER-SALES SERVICE

We pay the utmost attention in the quality of our products. However, if you are not satisfied, please contact our Customer Service (service.clients@fr.vwr.com) and indicate the reference and batch number of the product concerned.

This instruction for use was established on 26/11/15 and cancels all previous instructions. The information is based on our knowledge and our experience this day. The attention of the users is drawn on the eventual risks when the product is used for another use for which is dedicated. It is not exempt the user to know and implement all the texts regulating his activity. He will take under his responsibility the precautions bound in the use that he does of the product.